

Microsoft Word Online

Instructions

Accessing Word Online

You can access "Word Online" by going to my.littleover.derby.sch.uk through your internet browser and clicking on the **Word Online** tile.

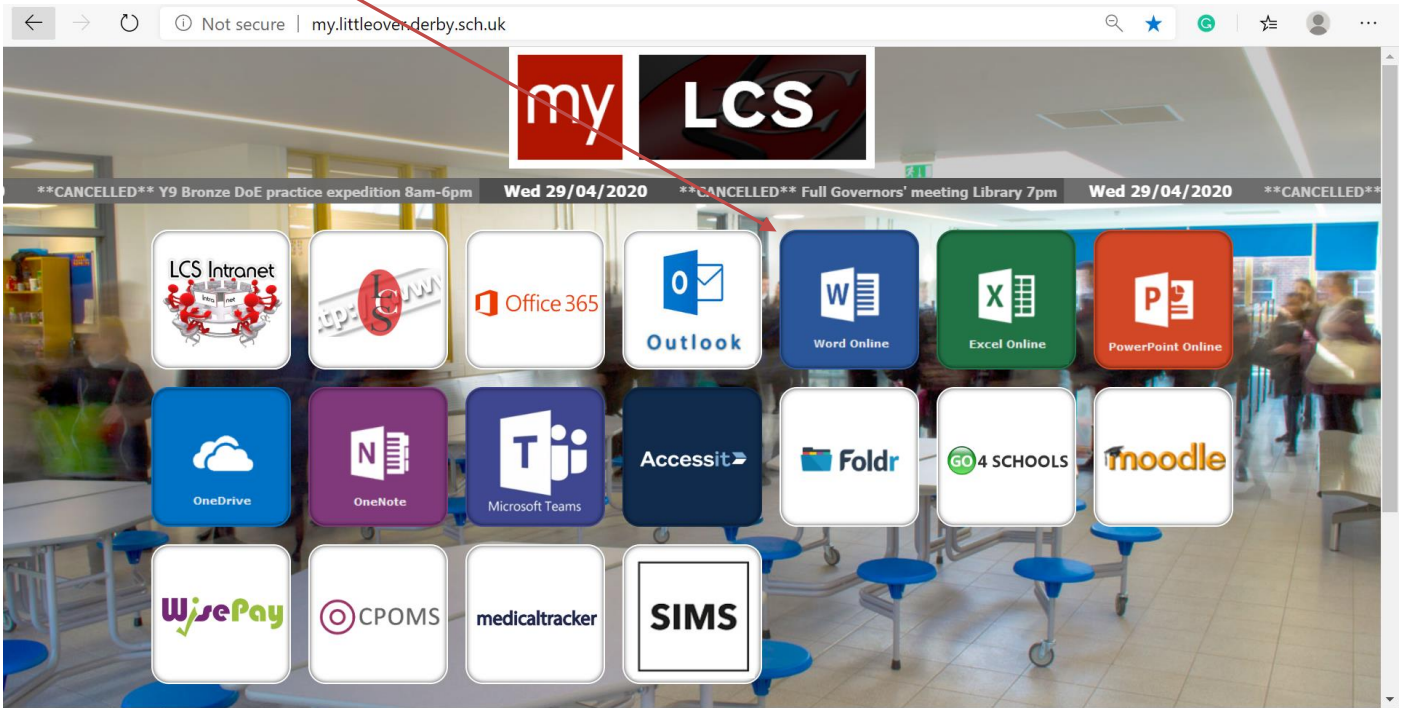

Once the page loads you will need to enter your school email address and click **next**.

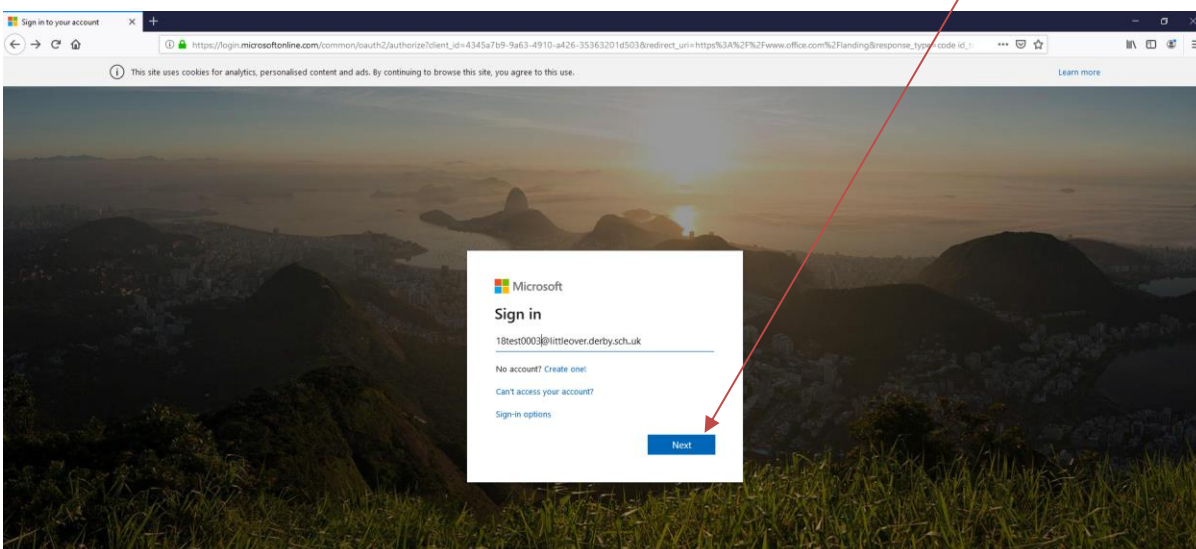

After doing this you will need to enter your password and click **Sign In**. This is the same password you use to sign in to the school computers.

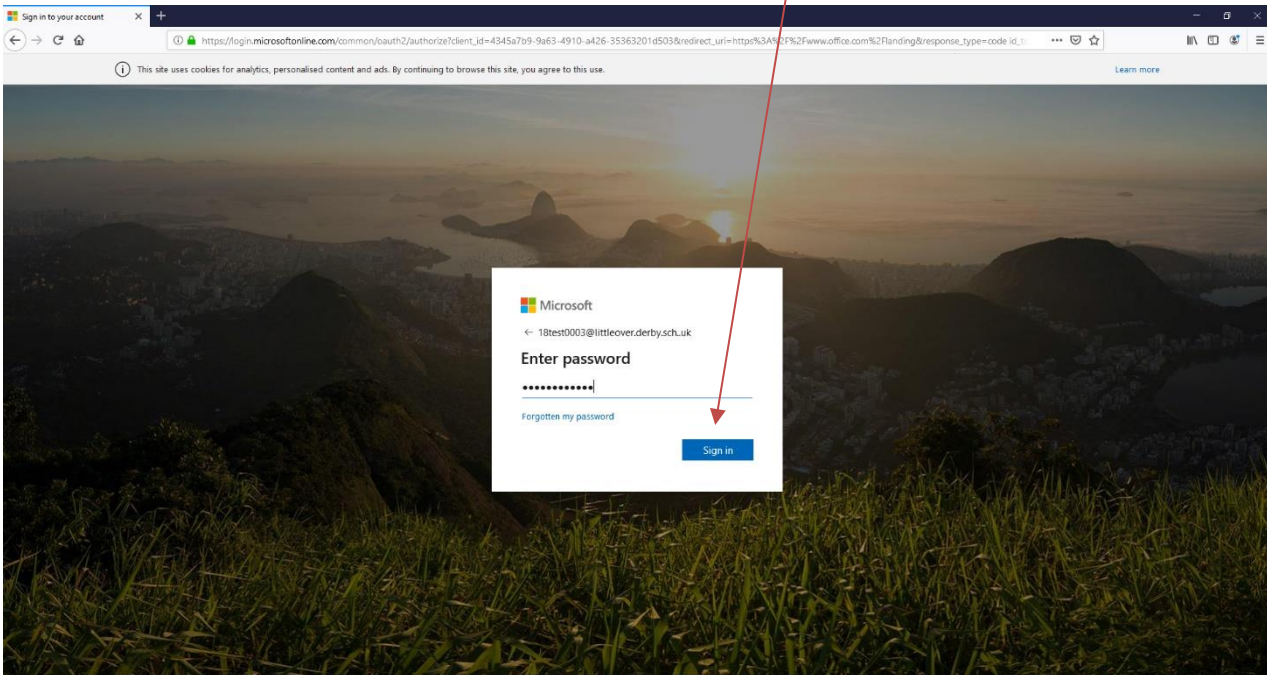

You should now have access to Word Online.